

DIN-Rail Unmanaged Industrial Ethernet Switch



UT-6408G

Gigabit 8-Port unmanaged Ethernet Switch



UTEK TECHNOLOGY (SHENZHEN) CO., LTD.

Add: Room 1001, Building 7, Skyworth Innovation Valley, No. 8, Tangtuo No.1 Road,
Shiyan Old Street, Bao 'an District, Shenzhen

Tel: +86-755-81202008

Fax: +86-755-27886083

Http: www.uotek.com





- Ensure reliable data transmission and long lifecycle
- Supports full-duplex and half-duplex, auto negotiation
- Auto-10/100/1000Mbps
- Fully automatic recognition of network interface
- Plug and play for easy access
- Operating temperature: -40 ~ 85°C
- Input voltage:12/24/48VDC(10.8~52.8VDC), supports reverse polarity protection



OVERVIEW

UT-6408G is a 8-port full Gigabit unmanaged Ethernet switch, providing 8 1000Base-T Ethernet port, which supports -40~85°C operating temperature and good EMC EMC performance, and also supports industry standard DIN-rail mounting and wall mounting to ensure normal operation in harsh environment, it is easy to install and apply on any industrial network.

SPECIFICATION

Protocol Standards

IEEE 802.3, 10 Base-T, IEEE 802.3u 100Base-TX,
IEEE 802.3ab 1000Base-T

Interfaces

Ethernet: 8*Gigabit RJ45, support 10/100/1000Base-T

LED indicator: power indicator, FAIL power failure light, RJ-45 indicator

Alarm contact: (UT-6408G) 1 relay output, normally open and normally closed

Switching Performance

Forwarding Rate: 1488095pps

Transmission mode: Store and Forward

MAC address size: 4K

Cache size: 1.5Mb

Backplane bandwidth: 18G

Max. frame length: 9720B

Mechanical Dimension

Dimension (W x D x H): 150mm x 100mm x 37mm

Weight: 0.9kg

Packaging dimension: 250mm x 205mm x 55mm

Power Requirement

Voltage input: 12/24/48VDC(10.8~52.8VDC),Redundant dual voltage input

Power consumption: 250mA@24Vmax

Terminal block: 1 pluggable 6-pin terminal block

Overload protection: Support

Reversal protection: Support

Operating Environment

Operating temperature: -40 ~ 85°C

Storage temperature: -40 ~ 85°C

Relative humidity: 0 ~ 95%

Mechanical Characteristics

IP protection level: IP40

Installation: DIN-Rail / Wall Mounted

Industrial Standards

EMI:

FCC Part 15 Subpart B class A, EN55022 class A

EMS:

IEC(EN)61000-4-2(ESD)

IEC(EN)61000-4-3(RS)

IEC(EN)61000-4-4(EFT)

IEC(EN)61000-4-5(Surge)

IEC(EN)61000-4-8

IEC(EN)61000-4-6(CS)

IEC 60068-2-27(Shock)

Dimension

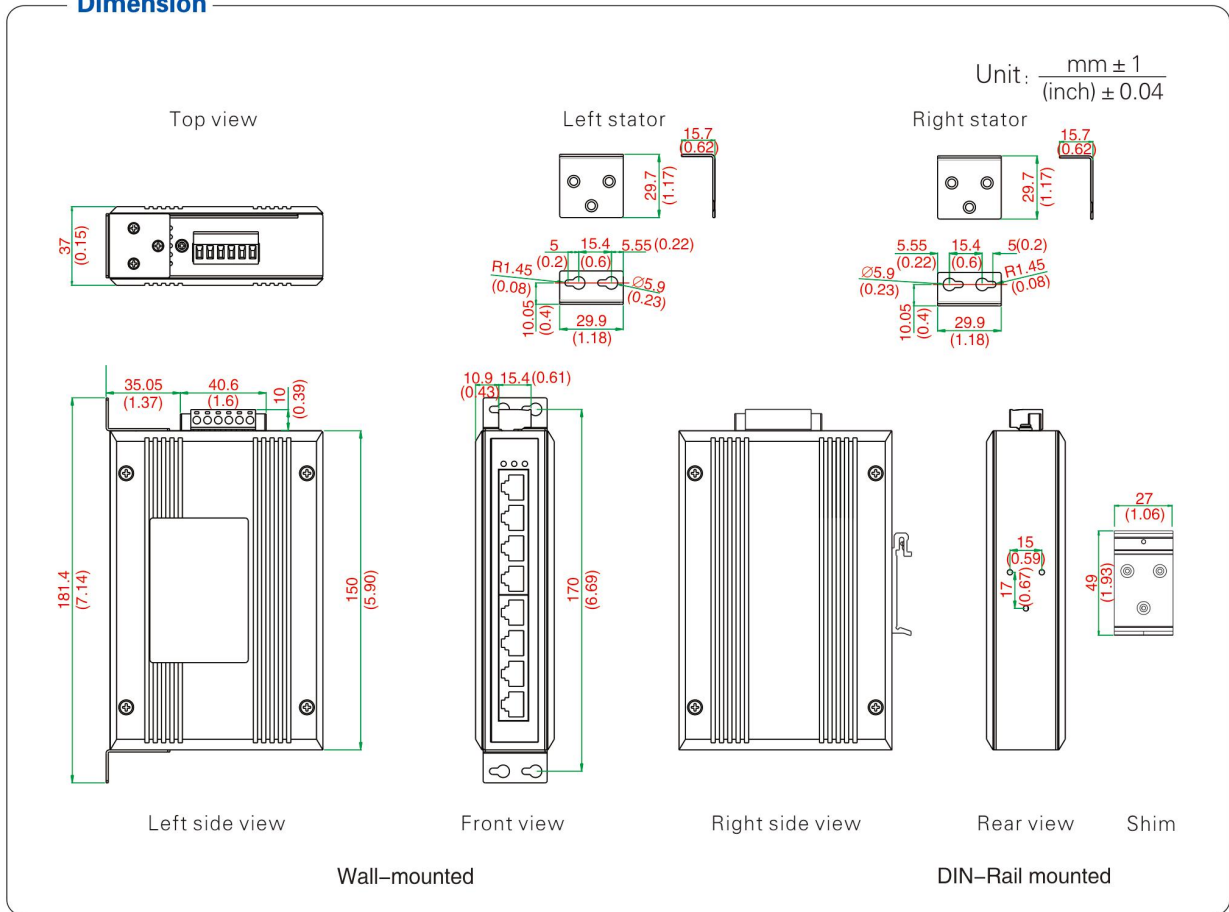

ORDERING

Model	Interface
	10/100/1000Base-T
UT-6408G	8