

# Gigabit 8-Port POE Unmanaged Ethernet Switch



## UT-6408G-POE

Gigabit 8-Port POE Unmanaged Ethernet Switch



### UTEK TECHNOLOGY (SHENZHEN) CO., LTD.

Add: Floor 8-10, Building 7, Skyworth Innovation Valley, No. 8, Tangtou No.1 Road, Shiyao Old Street, Bao'an District, Shenzhen

Tel: +86-755-81202008

Fax: +86-755-27886083

Http: [www.uotek.com](http://www.uotek.com)





- Support 8 ports POE Ethernet power supply
- Supports power abnormal state relay output alarm function
- Plug and play for easy access
- Operating temperature: -40~75°C



## OVERVIEW

The UT-6408G-POE is an 8-port full Gigabit unmanaged POE Ethernet switch with Gigabit Ethernet ports (supports POE Power over Ethernet E802.3af/at devices (PD)), eliminating the need for additional cabling, providing positive and negative DC input protection to prevent burnout of the switch, and a compact design that supports both industry standard DIN-rail and wall mounted installations, so it is easy to use in any industrial network.

## SPECIFICATION

### Protocol Standards

IEEE 802.3af/at(POE), IEEE 802.3 10Base-T, IEEE 802.3x  
IEEE 802.3u 100Base-T(X), IEEE 802.3ab 1000Base-T

### Interfaces

Ethernet interfaces: 8 x Gigabit RJ-45 (with POE output function). Supports 10/100/1000Base-T.  
Alarm contact: One relay output, NO/NC capacity 1A@24 VDC  
POE power supply method: +(1, 2)pins, -(3, 6)pins

### LED indicator light

Power indicator light, RJ45 indicator light, alarm indicator light, POE indicator light.

### Switching Performance

Forwarding rate: 1488095pps  
Transmission mode: store and forward  
MAC address size: 4K  
Cache size: 1.5Mb  
Backplane bandwidth: 18G  
Max. frame length: 9720B

### Power Requirement

Voltage input: 46-57 VDC, redundant dual voltage inputs  
Interface terminal: One pluggable 6-pin terminal block  
Overload protection: Support  
Reversal protection: Support

### Power Consumption

Single POE network interface up to 30W, total power consumption no more than 150W

### Mechanical Characteristics

IP protection level: IP40  
Installation: DIN-Rail /Wall Mounted

### Mechanical Dimension

Dimension (W x H x D): 47.6mm x 150mm x 100mm  
Package dimension: 250mm x 205mm x 55mm  
Weight: 810g

**Operating Environment**

Operating temperature: -40°C~85°C

Storage temperature: -40°C~85°C

Relative humidity: 0~95%

**Industrial Standards**

EMI:

FCC Part 15, CISPR(EN55022)class A

EMS:

IEC(EN)61000-4-2(ESD)

IEC(EN)61000-4-3(RS)

IEC(EN)61000-4-4(EFT)

IEC(EN)61000-4-5(Surge)

IEC(EN)61000-4-6(CS)

IEC(EN)61000-4-8

IEC60068-2-27( Shock)

IEC 60068-2-32(Freefall)

IEC 60068-2-6(Vibration)

**Dimension**

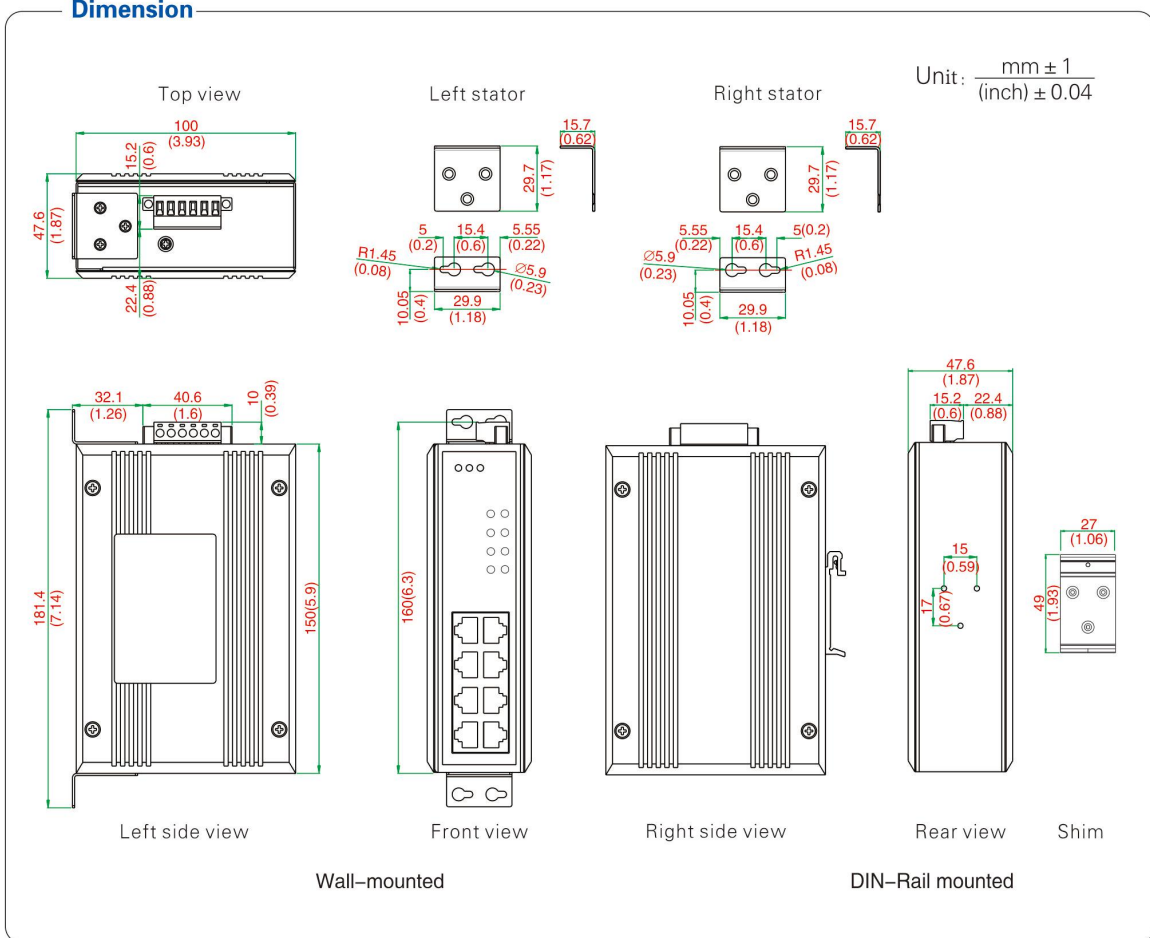

**ORDER INFORMATION**

Model	Interface description
	UT-6408G-POE
	8