

10/100M 8-Port Industrial Ethernet Switch



UT-6408W

10/100M 8-Port Industrial Ethernet Switch



UOTEK TECHNOLOGY (SHENZHEN) CO., LTD.

Add: Floor 8-10, Building 7, Skyworth Innovation Valley, No. 8, Tangtou No.1 Road, Shiyao Old Street, Bao'an District, Shenzhen

Tel: +86-755-81202008

Fax: +86-755-27886083

Http: www.uotek.com





- Supports full/half duplex mode, auto negotiation
- Auto 10/100Mbps
- Supports crossing-identification, no need manual operation
- Built-in store-and-forward, supports multiple protocols
- Operating temperature: -40 ~ 85°C
- Voltage input: 12/24/48VDC (10.8~52.8VDC), supports reverse connection protection
- Auto alarm function, via FAIL, relay output



OVERVIEW

UT-6408W is an industrial unmanaged Ethernet switch with 8 fast Ethernet ports. It supports DC input reverse polarity protection; this protects the device from burning. UT-6408W supports industrial standard Din-Rail and wall-mounted installation; it is easy to be installed at any industrial field.

SPECIFICATION

Protocol Standards

IEEE 802.3, IEEE 802.3u, IEEE 802.3x

Switching Performance

Forwarding rate: 148810pps

Transmission mode: store and forward

MAC address size: 2K

Cache size: 1Mb

Backplane bandwidth: 2G

Power Requirement

Voltage input: 12/24/48VDC(10.8~52.8VDC)

Dual power redundant input

Power Consumption: 120mA@24Vmax

Interface terminal: 1 pluggable 6 pin terminal

overload protection: Support

Reverse connect protection: Support

Mechanical Characteristics

IP protection level: IP40

Installation: Din-Rail/wall-mounted

Operating Environment

Operating temperature: -40 ~ 85°C

Storage temperature: -40 ~ 85°C

Relative humidity: 0~95% (non-condensing)

Interfaces

RJ45 port: 8 x10/100BaseT (X) ports, auto detection, full/half duplex, auto MDI/MDI-X

LED indicator: PWR1, PWR2, FAIL, RJ-45

Alarm contact: 1 channel relay output, NONC, 1A@24VDC

Mechanical Dimension

Dimension: 150mm×100mm×37mm

Weight: 700g

Package dimension: 250mm×205mm×55mm

Industrial Standards

EMI:

FCC Part 15 Subpart B classA, EN55022 class A

EMS:

IEC(EN)61000-4-2(ESD)

IEC(EN)61000-4-3(RS)

IEC(EN)61000-4-4(EFT)

IEC(EN)61000-4-5(Surge)

IEC(EN)61000-4-6(CS)

IEC(EN)61000-4-8

IEC60068-2-27(Shock)

IEC 60068-2-32(Freefall)

Dimension

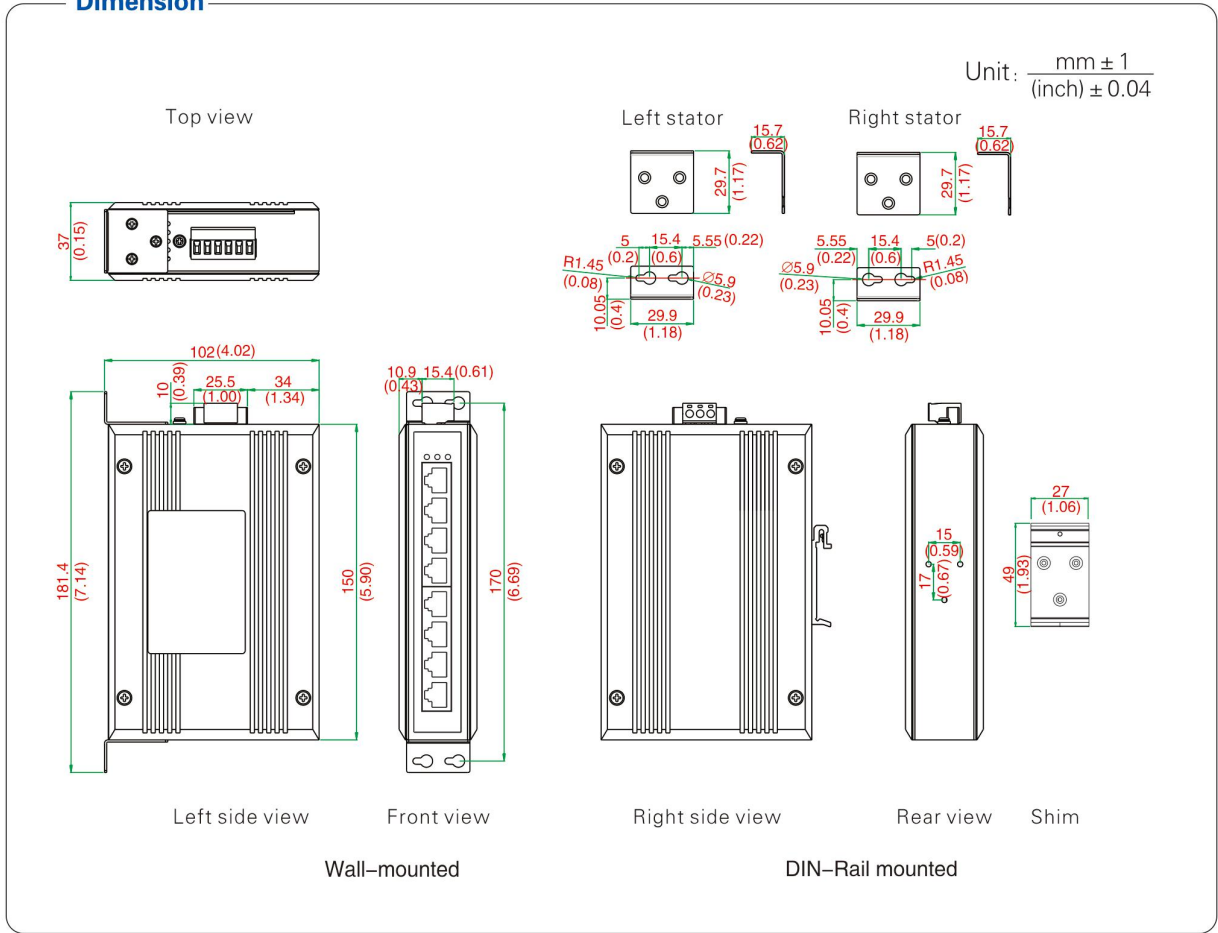

ORDER INFORMATION

Model	Interface
	10/100Base-T(X)
UT-6408W	8